

Electrolstatic discharge Protection Devices(ESD)

FEATURES

- Low Leakage Current
- Bi-direction high reliability

MECHANICAL DATA

- Case style:SOD-882 molded plastic
- Polarity:color band denotes positive end (cathode) except for bidirectional
- Mounting position:any

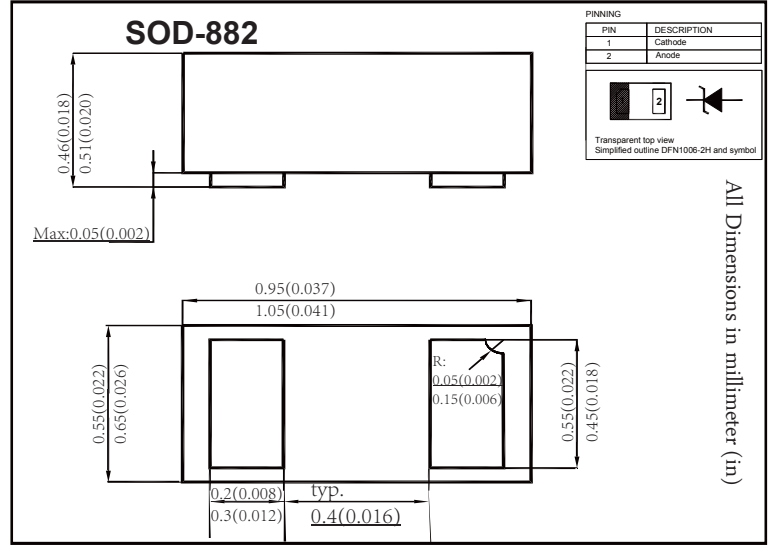

MAXIMUM RATINGS AND CHARACTERISTICS

@ 25°C Ambient Temperature (unless otherwise noted)

Absolute Maximum Ratings (T_a = 25°C)

| Parameter | Symbol | Value | Unit |
|---|------------------|---------------|------|
| IEC61000-4-2 (ESD) Contact | - | ± 30 | KV |
| Power Dissipation on FR-5 Board ¹⁾ | P _D | 150 | mW |
| Junction Temperature | T _j | - 55 to + 150 | °C |
| Storage Temperature Range | T _{stg} | - 55 to + 150 | °C |

¹⁾FR-5 = 1.0 x 0.75 x 0.62 in

Characteristics at T_a = 25°C (V_F = 0.9 V Max. at I_F = 10 mA)

| Type | Marking Code | Reverse Stand-off Voltage | Reverse Current | Breakdown Voltage | | Clamping Voltage | Reverse Peak Pulse Current | Peak Power Dissipation | Capacitance | | |
|----------|--------------|---------------------------|------------------------------------|-------------------|-------------------|---------------------------------------|----------------------------|--------------------------------|----------------|-------|-------------------|
| | | V _{RWM} | I _R at V _{RWM} | V _{BR} | at I _T | V _C at Max.I _{PP} | I _{PP} | P _{PK} (W) 8X20 μS | C _j | at f | at V _R |
| | | Max. (V) | Max. (μA) | Min. (V) | (mA) | Max. (V) | Max. (A) | Typ | Typ. (pF) | (MHz) | (V) |
| ESD9P3V3 | XA | 3.3 | 2.5 | 5 | 1 | 10.4 | 9.8 | 102 | 80 | 1 | 0 |
| ESD9P5V0 | XB | 5 | 1 | 6.2 | 1 | 12.3 | 8.7 | 107 | 65 | 1 | 0 |
| ESD9P12 | XC | 12 | 1 | 13.5 | 1 | 23.7 | 5.9 | 140 | 30 | 1 | 0 |

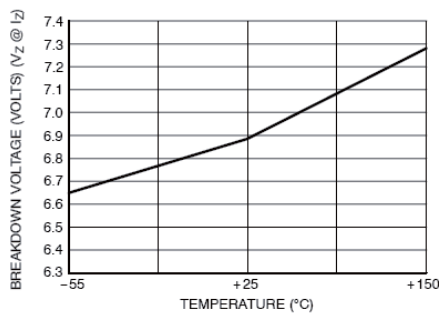

Figure 1. Typical Breakdown Voltage versus Temperature

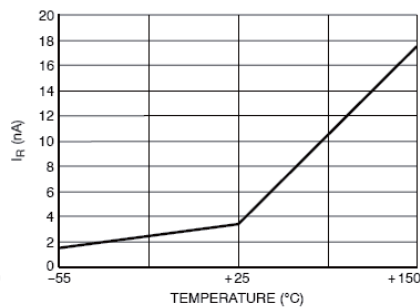

Figure 2. Typical Leakage Current versus Temperature