

## SCHOTTKY BARRIER DIODE

VOLTAGE RANGE: 40V  
PEAK PULSE POWER: 200mW

### FEATURES

- Low Forward Voltage
- Fast Switching

### MECHANICAL DATA

- Case: SOT-23 Small Outline Plastic Package
- Polarity: Color band denotes cathode end
- Mounting Position: Any

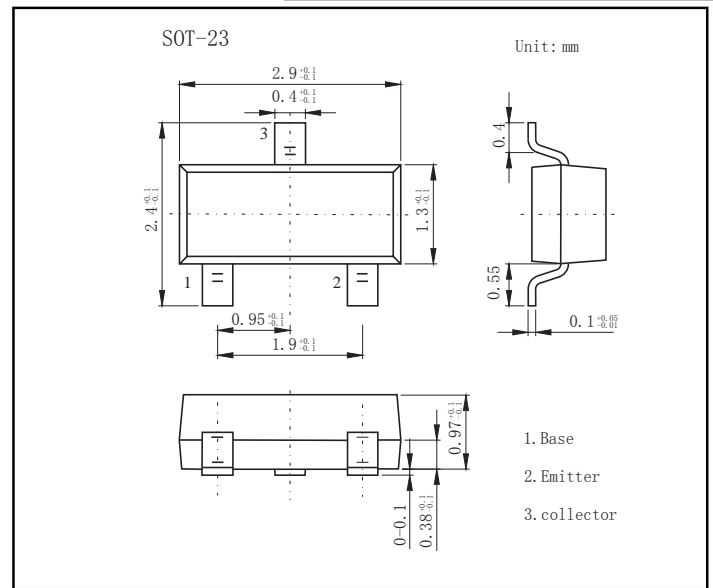

## MAXIMUM RATINGS AND CHARACTERISTICS

Ratings at 25 C ambient temperature unless otherwise specified

Parameter	Symbol	Limit	Unit
Peak repetitive peak reverse voltage	$V_{RRM}$	40	V
Working peak reverse voltage	$V_{RWM}$		
DC blocking voltage	$V_R$		
Forward continuous current	$I_{FM}$	200	mA
Power dissipation	$P_D$	200	mW
Thermal resistance junction to ambient	$R_{\theta JA}$	500	°C/W
Junction temperature	$T_J$	125	°C
Storage temperature range	$T_{STG}$	-55~+150	°C

## Electrical Specification ( $T_A=25^\circ\text{C}$ unless otherwise specified)

Parameter	Symbol	Test conditions	Min	Max	Unit
Reverse breakdown voltage	$V_{(BR)}$	$I_R=10\mu\text{A}$	40		V
Reverse voltage leakage current	$I_R$	$V_R=30\text{V}$		200	nA
Forward voltage	$V_F$	$I_F=1\text{mA}$ $I_F=40\text{mA}$		380 1000	mV
Diode capacitance	$C_D$	$V_R=0, f=1\text{MHz}$		5	pF
Reverse recovery time	$t_{rr}$	$I_{rr}=1\text{mA}, I_R=I_F=10\text{mA}$ $R_L=100\Omega$		5	ns

### MARKING:

BAS40	BAS40-06	BAS40-05	BAS40-04
43	46	45	44

# RATINGS AND CHARACTERISTIC CURVES

